



ASF25L1G - ASF25L1R - ASF25L1V - ASF25L2RV - ASF25L3GRV -
ASF25L1G230 - ASF25L1R230 - ASF25L1V230 - ASF25L2RV230 - ASF25L3GRV230

ASF50L1RV - ASF50L1RV230

ASF25L2RVD - ASF25L2RV230D

ASF1G - ASF1R - ASF1V - ASF2RV - ASF3GRV

Moving Ideas.

IT

EN

FR

ES

DE



AVVERTENZE



Questo manuale di istruzioni contiene importanti informazioni riguardanti la sicurezza: leggere attentamente tutte le istruzioni prima di procedere all'installazione. Stagnoli T.G. S.r.l. non si assume alcuna responsabilità per danni dovuti ad un uso improprio, erroneo ed irragionevole del prodotto. Conservare con cura questo manuale anche per utilizzi futuri.

DESTINAZIONI E LIMITI D'USO

Apollo è il semaforo progettato e prodotto da Stagnoli T.G. S.r.l. Apollo è stato pensato per usi privati, gestione di parcheggi, sensi unici alternati di zone condominiali. Apollo NON è un semaforo ad uso pubblico, strade autostrade etc. Stagnoli si riterrà sollevata da ogni responsabilità in caso di un uso ed una installazione impropria.

CARATTERISTICHE TECNICHE

DATI TECNICI	Lampada 230V	Verde 25 LED		Rosso 25 LED		Giallo 25 LED	
Alimentazione	230V	24V ac/dc	230V	24V ac/dc	230V	24V ac/dc	230V
Potenza*	75W	2,4W	3W	2,4W	3W	2,4W	3W
Corrente nominale assorbita	-	0,10A		0,10A		0,10A	
Luminosità(Lux)**	10-45lx	14lx		18lx		16lx	
Temperature di lavoro	-30° +70° C						
IP	66						

*Per schede a LED alimentate a 230V viene applicato un trasformatore da 3VA di potenza massima

**La luminosità è espressa in Lux, ma è relativa alla fonte luminosa

DICHIARAZIONE DI CONFORMITÀ



Il sottoscritto:
Albiero Lara
Legale rappresentante di Stagnoli T.G. S.r.l.

Il produttore:
Stagnoli T.G. S.r.l.

DICHIARA
che i prodotti denominati:
Serie APOLLO, semafori con corpo in alluminio,

ASF25L1G - ASF25L1R - ASF25L1V - ASF25L2RV - ASF25L3GRV - ASF25L1G230 - ASF25L1R230 - ASF25L1V230 - ASF25L2RV230
- ASF25L3GRV230 - ASF50L1RV - ASF50L1RV230 - ASF25L2RVD - ASF25L2RV230D - ASF1G - ASF1R - ASF1V - ASF2RV - ASF3GRV

SONO CONFORMI

DIRETTIVE 2014/30 UE (EMC), 2014/35 UE (LVD), 2011/65 UE (ROHS)

e a tutte le norme tecniche relative al prodotto entro il campo di applicabilità delle Direttive Comunitarie

EN IEC 61000-6-3:2021
EN IEC 61000-6-2:2019
EN IEC 63000:2018
EN 60068-2-1:2007
EN 60068-2-2:2007

EN 60529: 1991 A1: 2000 / A2:2013 / AC:2016 / AC: 2019

Questa dichiarazione viene emessa sotto la sola responsabilità del costruttore e, se applicabile, del suo rappresentante autorizzato.

Lonato del Garda, 10/10/2023

(Luogo e data)

(Firma)

DIMENSIONI ED INGOMBRI

SEMAFORO A 1 LUCE

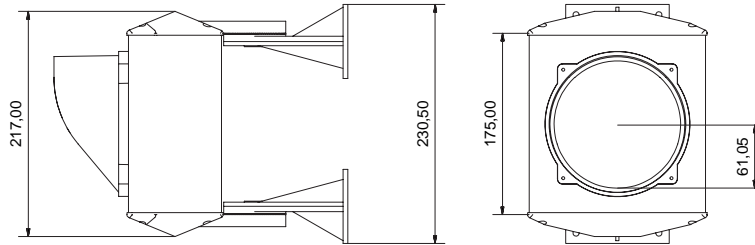

SEMAFORO A 2 LUCI

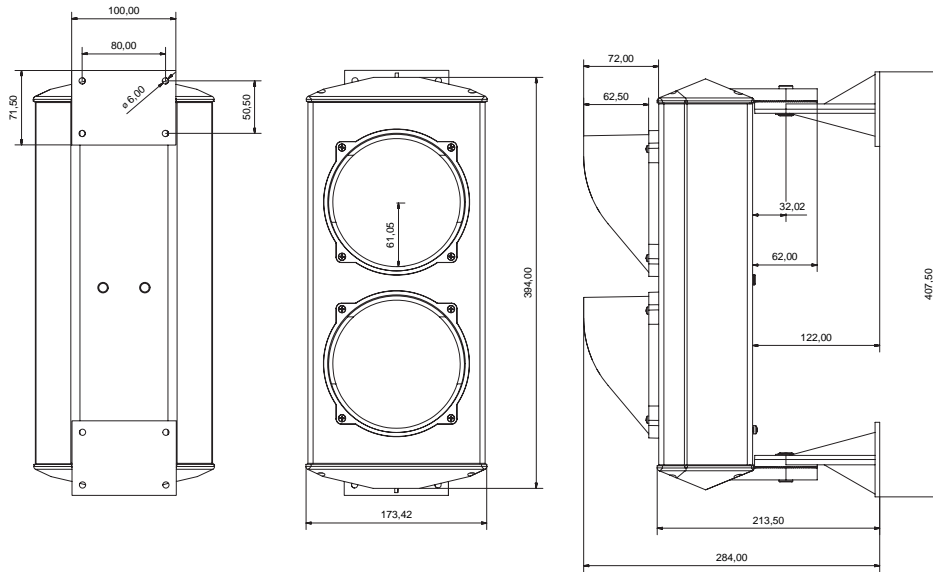

SEMAFORO A 3 LUCI

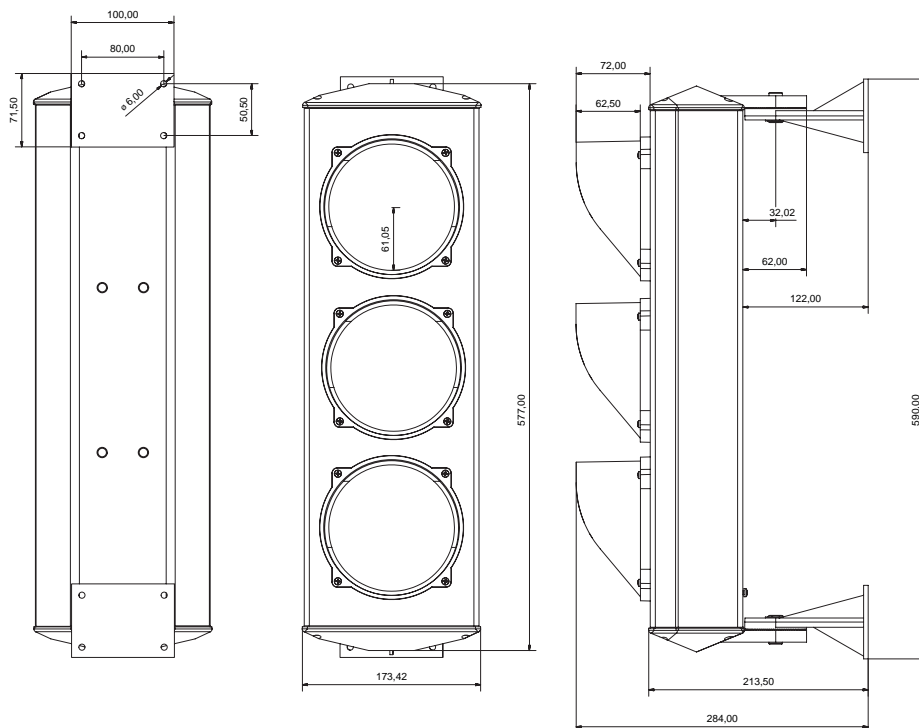

FISSAGGIO STAFFA A MURO

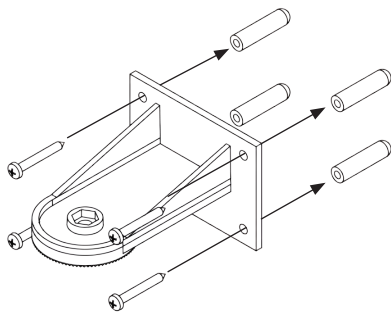
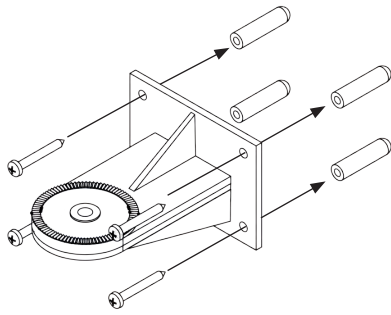

Trapano con punta da 8mm

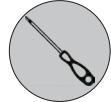

Giravite a croce

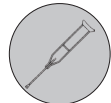

Giravite medio a taglio



Brugola esagonale N: 6

STRUMENTI UTILI

FISSAGGIO CORPO SU STAFFA

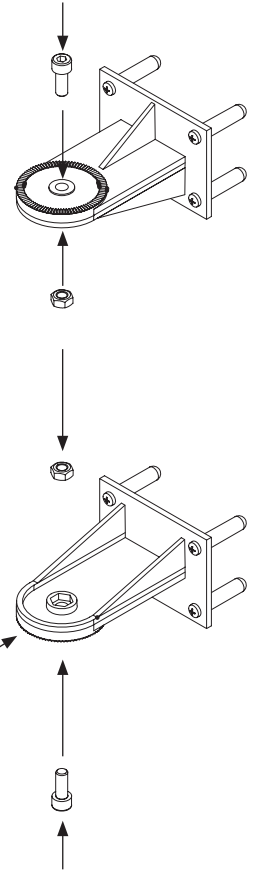
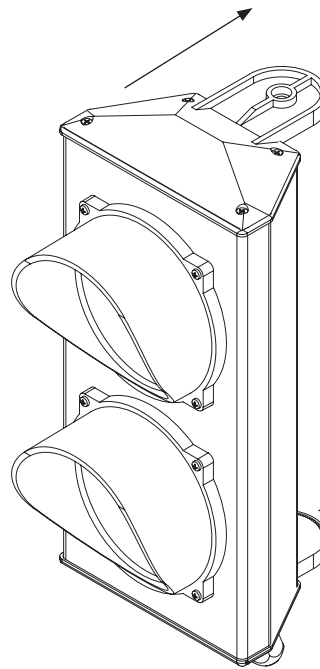

CABLAGGIO SCHEDA LED 24V

ASF25L1R

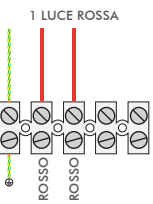

ASF25L1G

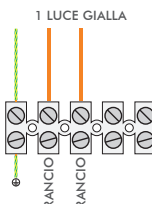

ASF25L1V

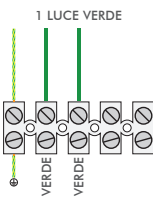

ASF25L2RV

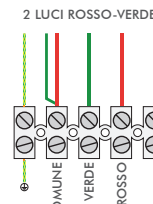

ASF50L1RV

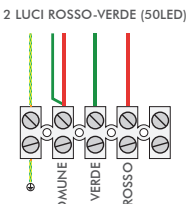

ASF25L3GRV

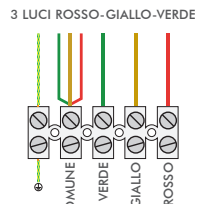

CABLAGGIO SCHEDA LED 230V

ASF25L1G230

ASF25L1R230

ASF25L1V230

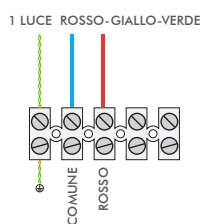

ASF25L2RV230

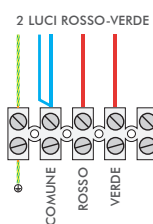

ASF50L1RV230

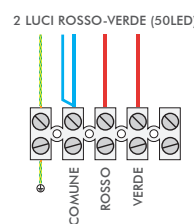

ASF25L3GRV230

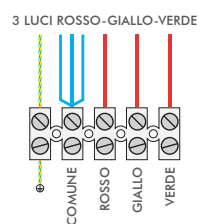

CABLAGGIO LAMPADA 230V

ASF1G
ASF1R
ASF1V

1 LUCE ROSSO-GIALLO-VERDE

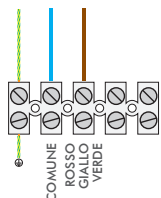

ASF2RV

2 LUCI ROSSO-VERDE

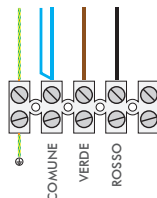

ASF3GRV

3 LUCI ROSSO-GIALLO-VERDE

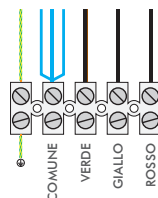

MONTAGGIO COPERCHIO SU SEMAFORO

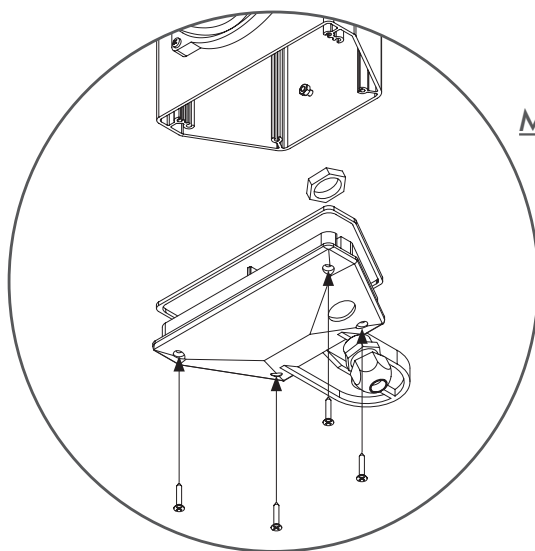

N.B.
serraggio viti
MIN: **4,5Nm**

STRUMENTI
UTILI

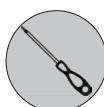

Giravite
a croce

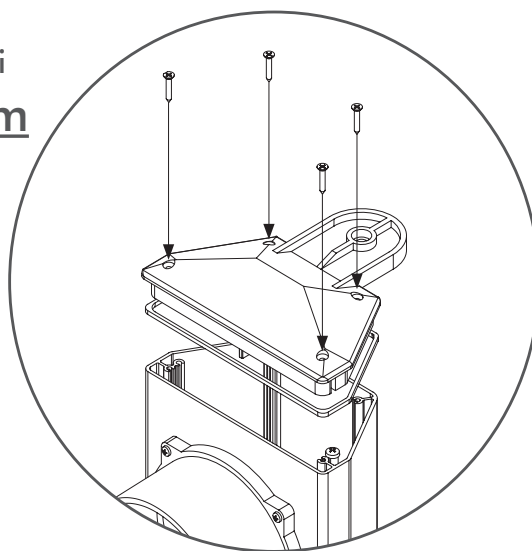

SMALTIMENTO



I componenti dell'imballo, cartone o plastiche, possono essere riciclati attraverso la raccolta differenziata. Nel caso di smaltimento del prodotto invece occorre fare molta attenzione ai componenti che possono contenere sostanze inquinanti quali schede elettroniche etc., che devono essere recuperati o smaltiti nei centri appositi o presso le ditte autorizzate. In questo caso occorre fare riferimento alle specifiche normative vigenti nel luogo di smaltimento.
NON DISPERDERE NELL'AMBIENTE.



Il simbolo del cestino barrato riportato sull'apparecchio indica che il prodotto, alla fine della propria vita utile, dovendo essere trattato separatamente dai rifiuti domestici, deve essere conferito in un centro di raccolta differenziata per apparecchiature elettriche ed elettroniche oppure riconsegnato al rivenditore al momento dell'acquisto di una nuova apparecchiatura equivalente.

L'utente è responsabile del conferimento dell'apparecchio a fine vita alle appropriate strutture di raccolta. L'adeguata raccolta differenziata per l'avvio successivo dell'apparecchio dismesso al riciclaggio, al trattamento e allo smaltimento ambientalmente compatibile contribuisce ad evitare possibili effetti negativi sull'ambiente e sulla salute e favorisce il riciclo dei materiali di cui è composto il prodotto. Per informazioni più dettagliate inerenti i sistemi di raccolta disponibili, rivolgersi al servizio locale di smaltimento rifiuti, o al negozio in cui è stato effettuato l'acquisto.

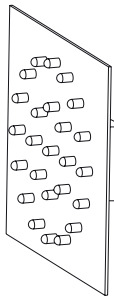

RSSA0011
RSSA0012
RSSA0013
RSSA0025

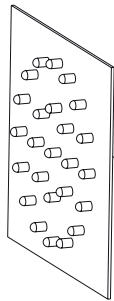

RSSA0008
RSSA0009
RSSA0010
RSSA0018

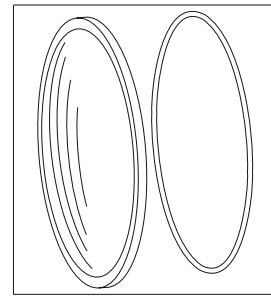

RSSA0001
RSSA0002
RSSA0003
RSSA0026

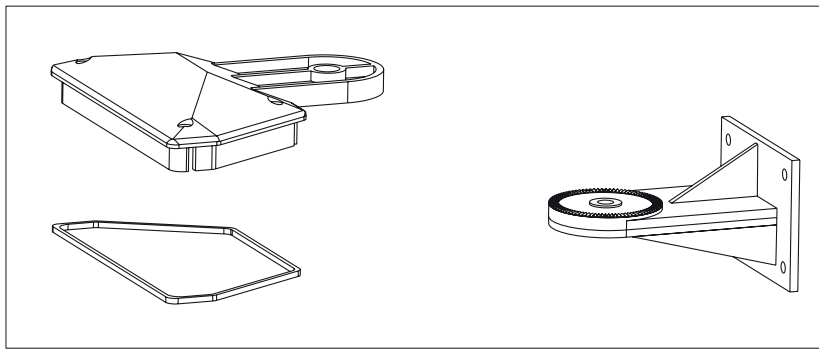

RSSA0004

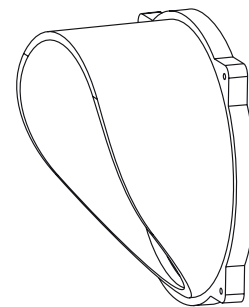

RSSA0005

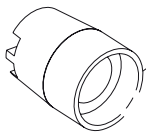

RSSA0007



RSSA0006

- ASFK230 Trasformatore da 230V a 24V
- RSSA0001 Lente rossa con guarnizione per semafori Apollo.
- RSSA0002 Lente gialla con guarnizione per semafori Apollo.
- RSSA0003 Lente verde con guarnizione per semafori Apollo.
- RSSA0026 Lente neutra con guarnizione per semafori Apollo.
- RSSA0004 Kit composto da coperchio staffa e guarnizione per semafori Apollo.
- RSSA0005 Parasole per semafori Apollo.
- RSSA0006 Lampada da 70W per semafori Apollo.
- RSSA0007 Porta lampada E27 in ceramica per semafori Apollo.
- RSSA0008 Scheda a 24V ac/dc con 25 LED rossi.
- RSSA0009 Scheda a 24V ac/dc con 25 LED gialli.
- RSSA0010 Scheda a 24V ac/dc con 25 LED verdi.
- RSSA0011 Scheda a 230V ac con 25 LED rossi e trasformatore.
- RSSA0012 Scheda a 230V ac con 25 LED gialli e trasformatore.
- RSSA0013 Scheda a 230V ac con 25 LED verdi e trasformatore.
- RSSA0025 Scheda a 230V ac con 50 LED rossi e verdi incluso trasformatore.
- RSSA0018 Scheda a 24V ac/dc con 50 LED rossi e verdi.

ATTENZIONE!!
CONSERVARE QUESTO FOGLIO COMPILATO UNITAMENTE AL DOCUMENTO COMPROVANTE
L'ACQUISTO DEL PRODOTTO DA ESIBIRE PER FAR VALERE LA GARANZIA

DATI DEL VENDITORE*

Timbro – con indicazione di nome, indirizzo e numero di telefono e firma del venditore

DATI DELL'INSTALLATORE*

Timbro – con indicazione di nome, indirizzo e numero di telefono e firma dell'installatore

DATI DEL PRODOTTO

Nome* _____

Codice* _____

N. di serie* _____

DATI DI MANUTENZIONE

Data dell'intervento* _____

Dati dell'operatore e (nome, indirizzo) e firma* _____

DATI DELL'INSTALLAZIONE

Indirizzo del luogo di installazione _____

N. tel. del proprietario dell'impianto _____

Data di installazione * _____

EVENTUALI SEGNALAZIONI



WARNING



This instruction manual contains important information concerning safety: read all instructions carefully before proceeding with installation. Stagnoli T.G. S.r.l. assumes no responsibility for damage caused by an to improper, erroneous and unreasonable use of the product. Keep this manual carefully for future use as well.

DESTINATIONS AND LIMITS OF USE

Apollo is the traffic light designed and produced by Stagnoli T.G. S.r.l. Apollo was designed for private use, management of parking lots, alternating one-way streets of condominium areas. Apollo is NOT a traffic light for public use, roads, highways etc. Stagnoli T.G. S.r.l. will be relieved of any responsibility in the event of improper use and installation.

TECHNICAL FEATURES

TECHNICAL DATA	Lamp 230V	Green 25 LED		Red 25 LED		Yellow 25 LED	
Power supply	230V	24V ac/dc	230V	24V ac/dc	230V	24V ac/dc	230V
Power*	75W	2,4W	3W	2,4W	3W	2,4W	3W
Nominal current consumption	-	0,10A		0,10A		0,10A	
Brightness(Lux)**	10-45lx	14lx		18lx		16lx	
Working temperatures	-30° +70° C						
IP	66						

*For 230V powered LED boards, a 3VA transformer of maximum power is applied

** Brightness is expressed in Lux, but deperst to the light source

DECLARATION OF CONFORMITY



The undersigned:
Albiero Lara
Legal representative of Stagnoli T.G. S.r.l.

The manufacturer:
Stagnoli T.G. S.r.l.

DECLARES

that the products named:
APOLLO series, traffic lights with aluminum body

ASF25L1G - ASF25L1R - ASF25L1V - ASF25L2RV - ASF25L3GRV - ASF25L1G230 - ASF25L1R230 - ASF25L1V230 - ASF25L2RV230
- ASF25L3GRV230 - ASF50L1RV - ASF50L1RV230 - ASF25L2RVD - ASF25L2RV230D - ASF1G - ASF1R - ASF1V - ASF2RV - ASF3GRV

ARE IN COMPLIANCE WITH
DIRECTIVES 2014/30 UE (EMC), 2014/35 UE (LVD), 2011/65 UE (ROHS)

and with all the technical standards relating to the product within the field of applicability of the Community Directives

EN IEC 61000-6-3:2021
EN IEC 61000-6-2:2019
EN IEC 63000:2018
EN 60068-2-1:2007
EN 60068-2-2:2007

EN 60529: 1991 A1: 2000 / A2:2013 / AC:2016 / AC: 2019

This declaration is issued under the sole responsibility of the manufacturer and, if applicable, his authorized representative.

Lonato del Garda, 10/10/2023

(Place and date)

(Signature)

DIMENSIONS AND SIZE

TRAFFIC LIGHT WITH 1 LIGHT

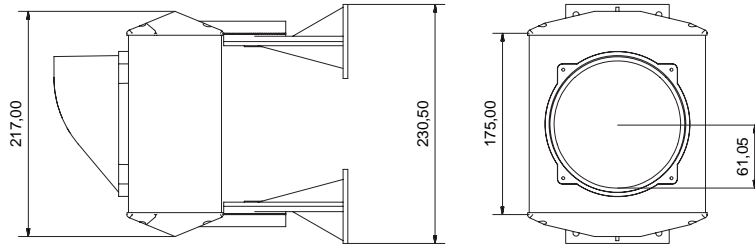

TRAFFIC LIGHT WITH 2 LIGHTS

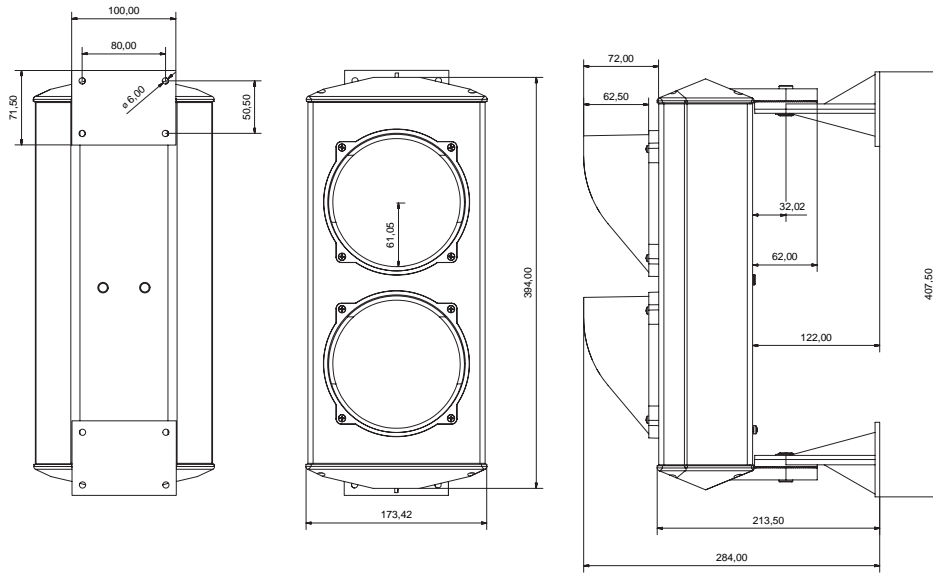

TRAFFIC LIGHT WITH 3 LIGHTS

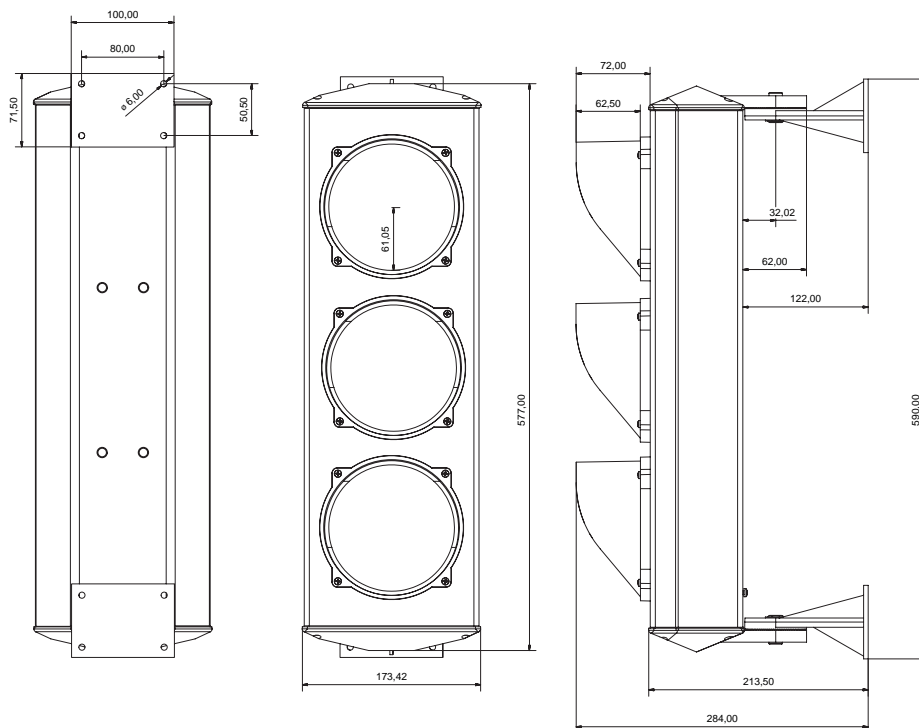

FIXING THE BRACKET TO THE WALL

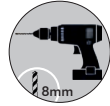
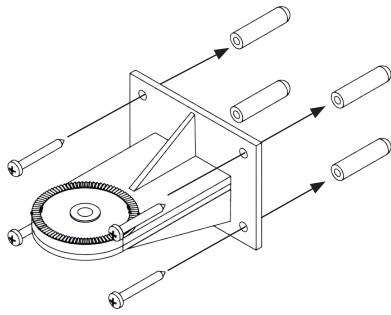

Drill with 8mm bit

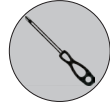

Phillips screwdriver

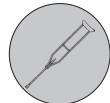

Flat screwdriver



Hexagonal Allen Ke N: 6

USEFUL TOOLS

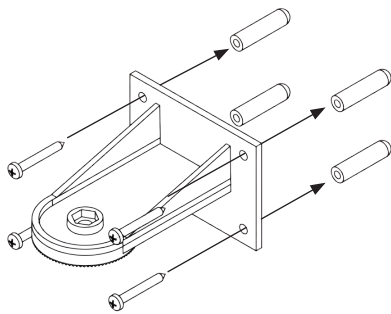

BODY FIXING ON BRACKET

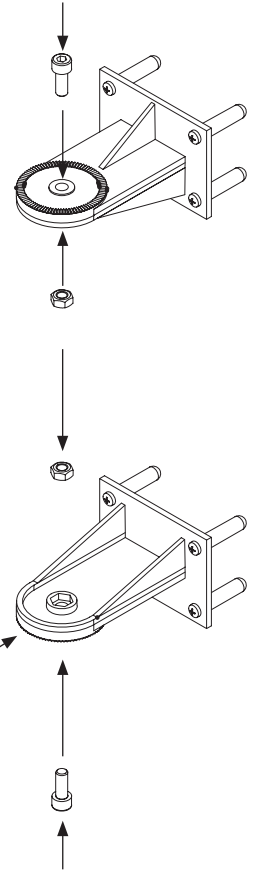
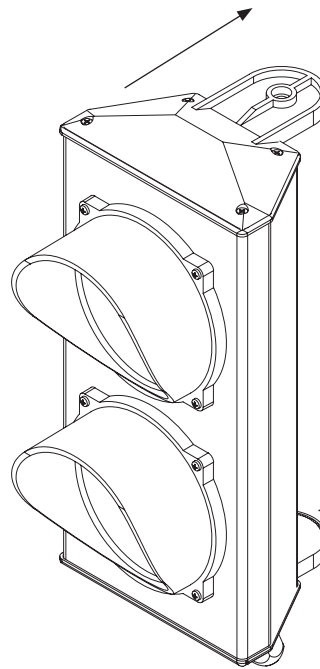

24V LED BOARD WIRING

ASF25L1R

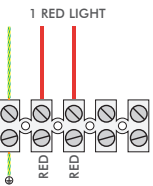

ASF25L1G

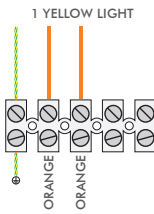

ASF25L1V

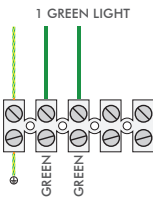

ASF25L2RV

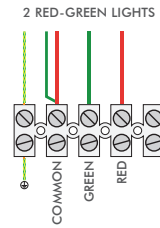

ASF50L1RV

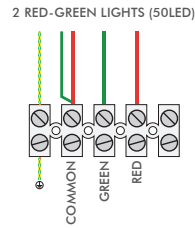

ASF25L3GRV

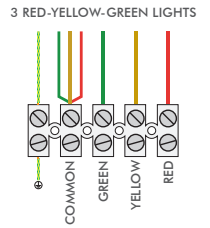

230V LED BOARD WIRING

ASF25L1G230

ASF25L1R230

ASF25L1V230

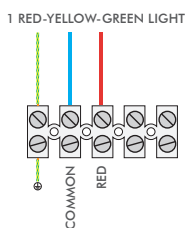

ASF25L2RV230

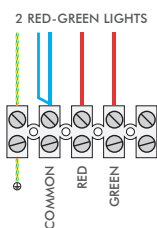

ASF50L1RV230

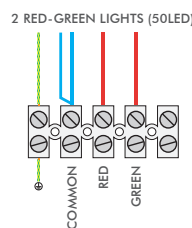

ASF25L3GRV230

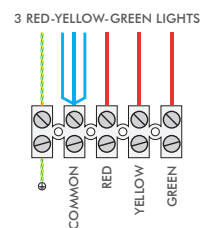

230V LAMP WIRING

ASF1G
ASF1R
ASF1V

1 RED-YELLOW-GREEN LIGHT

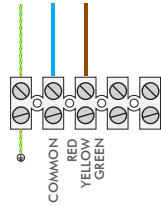

ASF2RV

2 RED-GREEN LIGHTS

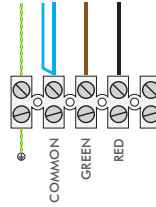

ASF3GRV

3 RED-YELLOW-GREEN LIGHTS

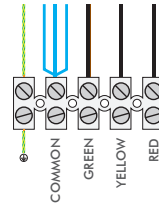

COVER ASSEMBLY ON TRAFFIC LIGHTS

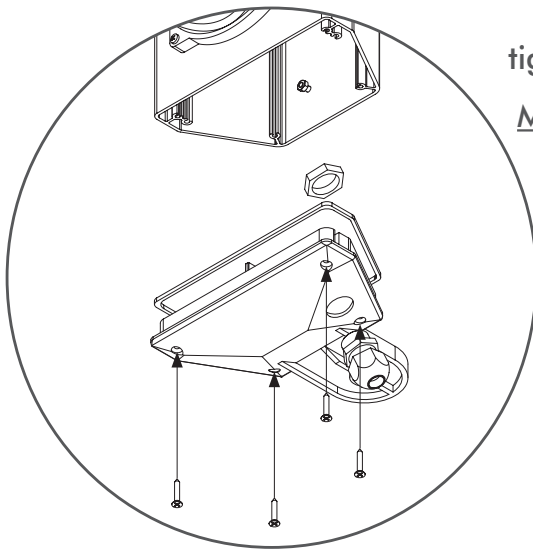

NOTE
tightening screws
MIN: **4,5Nm**

USEFUL
TOOLS

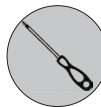

Phillips
screwdr

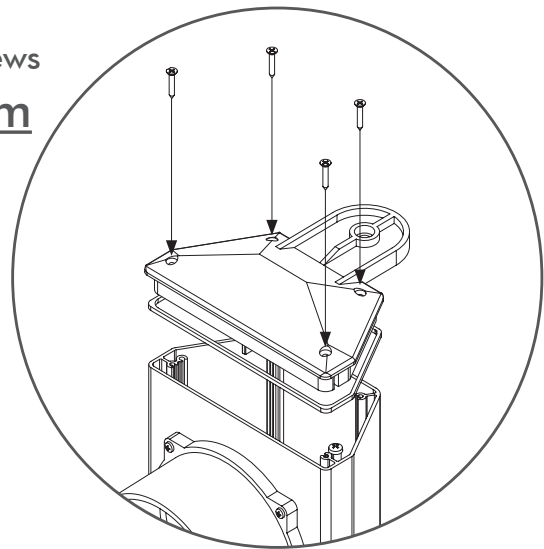

DISPOSAL



The packaging components, cardboard, or plastic can be recycled through separate collection. In the case of disposal of the product, you have to pay attention to components that may contain pollutants such as circuit boards etc., which must be retrieved or disposed of in special centres or at authorized facilities. In this case it is necessary to refer to the specific regulations into force in the place of disposal.

The crossed-out waste bin symbol on the appliance or on its packaging means that at the end of its service life, having to be treated separately from household waste, it must be taken to a separate collection centre for electrical and electronic equipment. Otherwise, the user can return it to the retailer at the time of purchase of a new type of equivalent device.

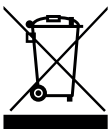

The user is responsible for providing the appliance at the end of its life to the appropriate collection facilities. The adequate whit allows separate collection the recycling, treatment and environmentally compatible disposal, helps prevent negative impact on the environment and human health, and promotes the recycling of the materials making up the product. For MORE detailed information regarding the collection systems available, contact the local waste disposal service or the shop where the purchase was made.

SPARE PARTS

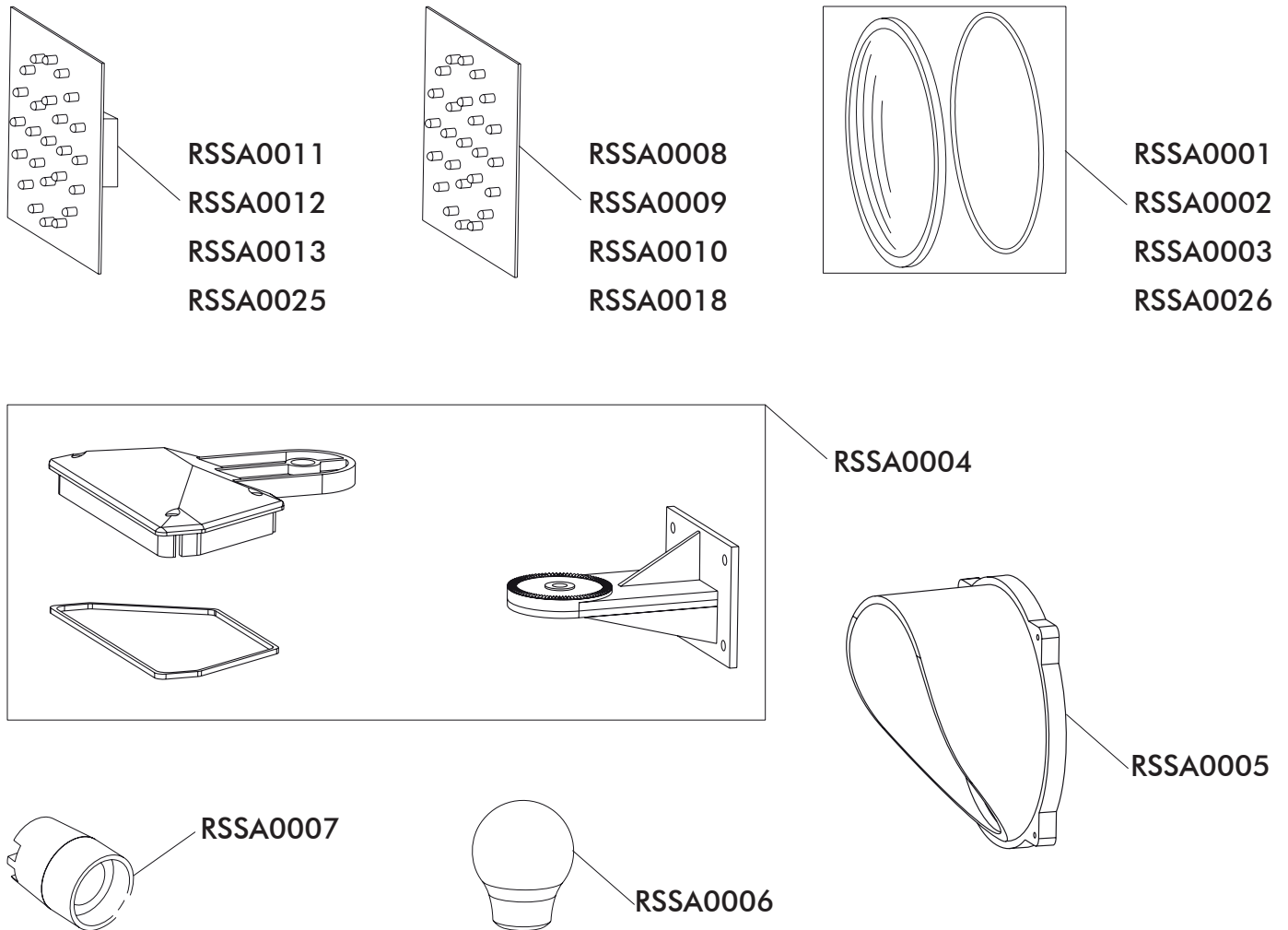

ASFK230 Transformer from 230V to 24V

RSSA0001 Red lens with gasket for Apollo traffic lights.

RSSA0002 Yellow lens with gasket for Apollo traffic lights.

RSSA0003 Green lens with gasket for Apollo traffic lights.

RSSA0026 Neutral lens with gasket for Apollo traffic lights.

RSSA0004 Kit consisting of bracket cover and gasket for Apollo traffic lights.

RSSA0005 Sunshade for Apollo traffic lights.

RSSA0006 70W lamp for Apollo traffic lights.

RSSA 0007 E27 ceramic lamp holder for Apollo traffic lights.

RSSA0008 24V ac/dc card with 25 red LEDs.

RSSA0009 24V ac/dc card with 25 yellow LEDs.

RSSA0010 24V ac/dc card with 25 green LEDs.

RSSA0011 230V ac board with 25 red LEDs and transformer.

RSSA0012 230V ac board with 25 yellow LEDs and transformer.

RSSA0013 230V ac board with 25 green LEDs and transformer.

RSSA0025 230V ac board with 50 red and green LEDs including transformer.

RSSA0018 24V ac/dc card with 50 red and green LEDs.

WARRANTY

ATTENTION!!
PLEASE KEEP THIS FORM AND FILL IT UP FOR WARRANTY PURPOSE. PLEASE ALWAYS INCLUDE A COPY OF THE BILL AS WELL

VENDOR DATA*

Stamp with vendor name, address, phone number and signature

INSTALLER DATA*

Stamp with installer name, address, phone number and signature

PRODUCT DATA

Name *

Part nr.*

Operator serial nr.*

MAINTENANCE DATA

Date of the intervention*

Person in charge of maintenance (name, address) and signature*

INSTALLER DATA

Installation address*

Phone nr. of the installation owner

Date of installation*

INDICATIONS:



AVERTISSEMENT



Ce manuel d'instructions contient des informations importantes pour ce qui concerne la sécurité: lisez toutes les instructions avec soin avant de procéder à l'installation. Stagnoli T.G. S.r.l. n'assume aucune responsabilité pour des dommages causés par une utilisation incorrecte, erronée ou déraisonnable du produit. Conservez ce manuel sûr pour utilisation future.

DESTINATIONS ET LIMITES D'UTILISATION

Apollo et pour est le feu de circulation conçu et produit par Stagnoli T.G. S.r.l. Apollo a été conçu pour un usage privé et une la gestion des stationnements, alterner des rues à sens unique des zones de condominiums. Apollo n'est PAS un feu de circulation pour usage public sur les routes, les autoroutes, etc., Stagnoli T.G. S.r.l. sera exemptée de toute responsabilité dans le cas d'une mauvaise installation ou utilisation.

CARACTÉRISTIQUES TECHNIQUES

DONNÉES TECHNIQUES	Lampe 230V	Vert 25 LED		Rouge 25 LED		Jaune 25 LED	
Alimentation	230V	24V ac/dc	230V	24V ac/dc	230V	24V ac/dc	230V
Puissance *	75W	2,4W	3W	2,4W	3W	2,4W	3W
Consommation nominale	-	0,10A		0,10A		0,10A	
Luminosité (Lux)**	10-45lx	14lx		18lx		16lx	
Températures de fonctionnement	-30° +70° C						
IP	66						

* Pour les circuits DEL de 230 V, un transformateur de 3 VA maximum est utilisé.

** La luminosité est exprimée en Lux, mais elle est relative à la source de lumière

DÉCLARATION DE CONFORMITÉ



Le soussigné :
Albiero Lara
Représentant légal de Stagnoli T.G. S.r.l.

Le fabricant:
Stagnoli T.G. S.r.l.

DÉCLARE
que les produits nommés :

Série APOLLO, feux de circulation avec boîtier en aluminium,
ASF25L1G - ASF25L1R - ASF25L1V - ASF25L2RV - ASF25L3GRV - ASF25L1G230 - ASF25L1R230 - ASF25L1V230 - ASF25L2RV230
- ASF25L3GRV230 - ASF50L1RV - ASF50L1RV230 - ASF25L2RVD - ASF25L2RV230D - ASF1G - ASF1R - ASF1V - ASF2RV - ASF3GRV

sont CONFORMES AUX

DIRECTIVES 2014/30 UE (EMC), 2014/35 UE (LVD), 2011/65 UE (ROHS)

avec toutes les normes techniques reliées aux produits dans le champ d'application des directives de la Communauté

EN IEC 61000-6-3:2021

EN IEC 61000-6-2:2019

EN IEC 63000:2018

EN 60068-2-1:2007

EN 60068-2-2:2007

EN 60529: 1991 A1: 2000 / A2:2013 / AC:2016 / AC: 2019

Cette déclaration est émise sous la seule responsabilité du fabricant et, s'il y a lieu, de son représentant légal.

Lonato del Garda, 10/10/2023

(Lieu et date)

(Signature)

DIMENSIONS ET TAILLES

FEU DE CIRCULATION SIMPLE

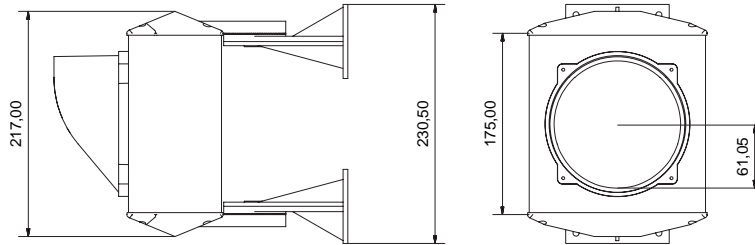

FEU DE CIRCULATION DOUBLE

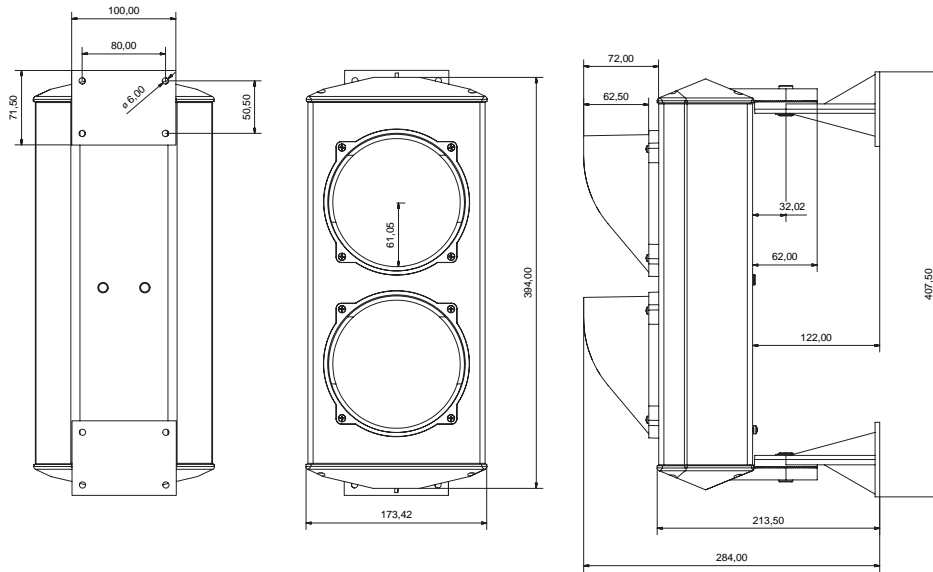

FEU DE CIRCULATION TRIPLE

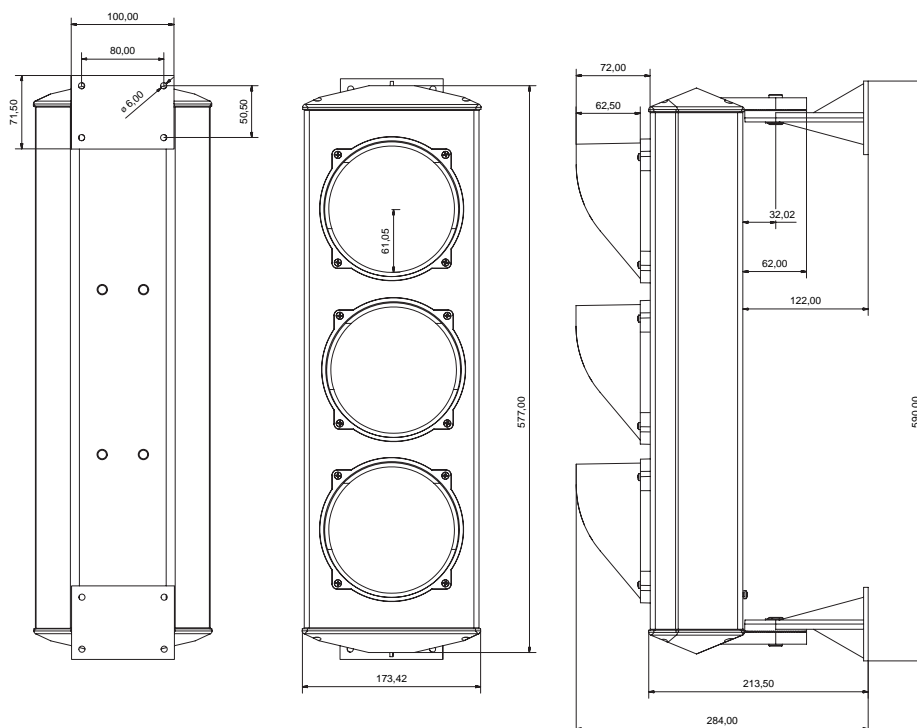

FIXATION DU SUPPORT AU MUR

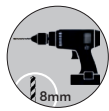
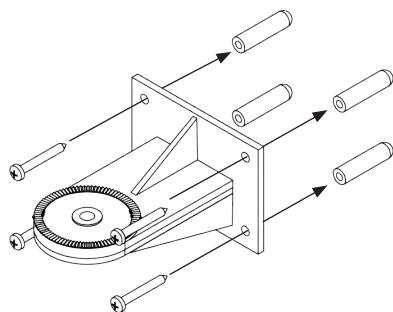

Perceuse avec foret de 8 mm

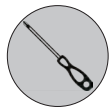

Tournevis cruciforme



Tournevis plat



Clé hexagonale Allen N°6

OUTILS UTILES

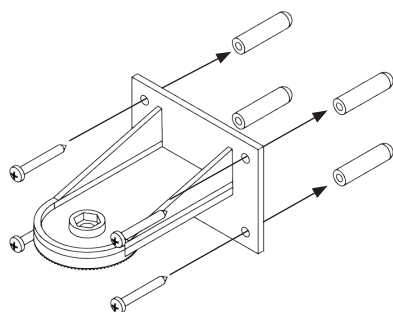

FIXATION DU CORPS SUR LE SUPPORT

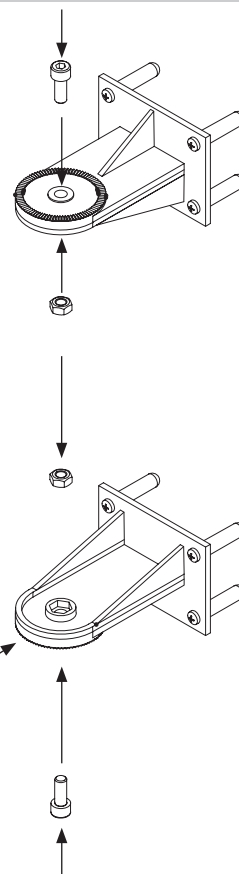
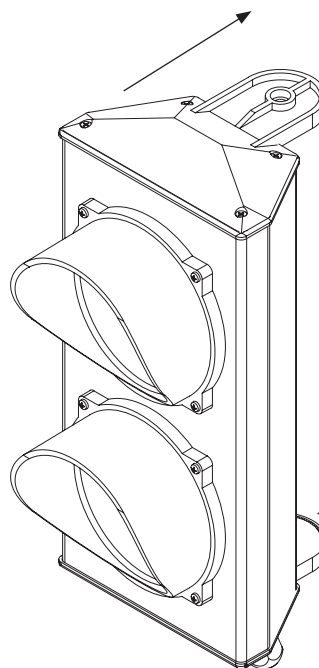

CÂBLAGE PANNEAU DEL 24V

ASF25L1R

1 FEU ROUGE

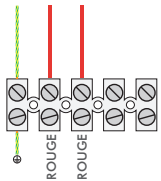

ASF25L1G

1 FEU JAUNE

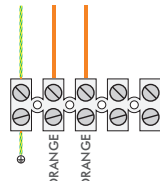

ASF25L1V

1 FEU VERT

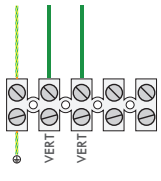

ASF25L2RV

2 FEUX ROUGE-VERT

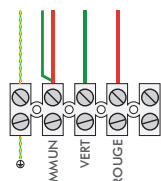

ASF50L1RV

2 FEUX ROUGE-VERT (50LED)

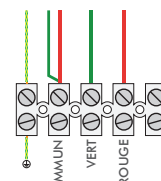

ASF25L3GRV

3 FEUX ROUGE-JAUNE-VERT

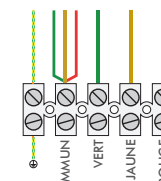

CÂBLAGE PANNEAU DEL 230 V

ASF25L1G230

ASF25L1R230

ASF25L1V230

1 FEU ROUGE - JAUNE - VERT

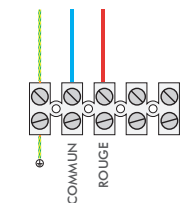

ASF25L2RV230

2 FEUX ROUGE - VERT

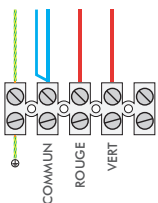

ASF50L1RV230

2 FEUX ROUGE - VERT (50LED)

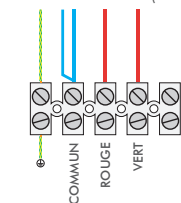

ASF25L3GRV230

3 FEUX ROUGE - JAUNE - VERT

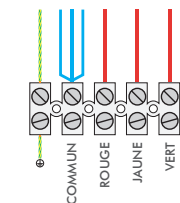

CÂBLAGE LAMPE 230 V

ASF1G
ASF1R
ASF1V

1 FEU ROUGE-JAUNE-VERT

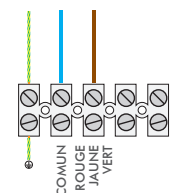

ASF2RV

2 FEUX ROUGE-VERT

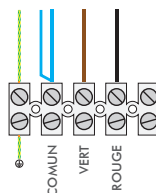

ASF3GRV

3 FEUX ROUGE-JAUNE-VERT

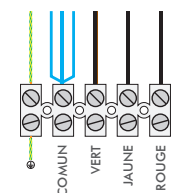

ASSEMBLAGE DU BOÎTIER DU FEU DE CIRCULATION

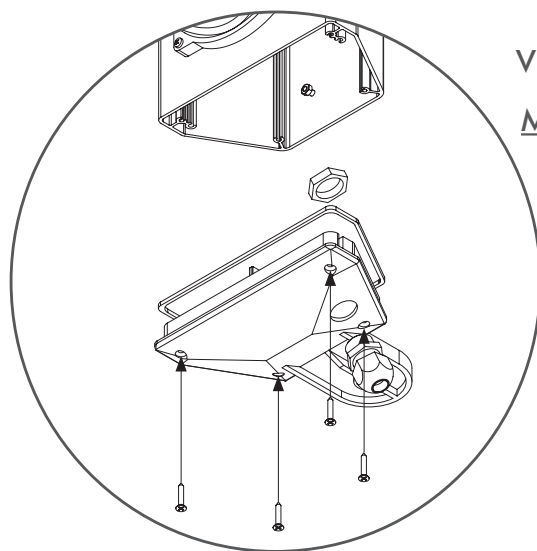

NOTE
Vis de serrement
MIN: 4,5Nm

OUTILS
UTILISÉS



Tournevis
cruciforme

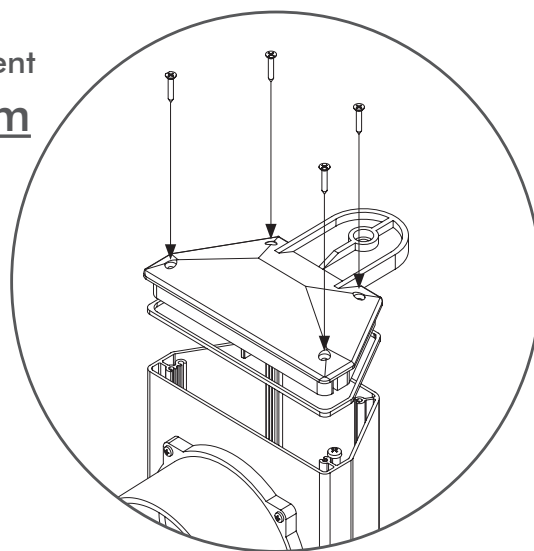

DISPOSITION



Les composants de l'emballage, carton ou plastique, peuvent être recyclés par la collecte sélective. Dans le cas de l'écoulement des produits, il faut prêter attention aux composants qui pourraient contenir des polluants comme les circuits imprimés, etc., qui doivent être récupérés ou disposés dans des centres spéciaux ou des installations autorisées. Dans ce cas, il est nécessaire de vous référer aux réglementations en vigueur à dans le de disposition. **ÉVITEZ DE DÉPOSER DANS L'ENVIRONNEMENT.**

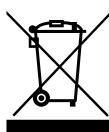

Le symbole de poubelle barrée sur l'appareil ou son emballage signifie qu'à la fin de sa vie utile, il doit être traité séparément des déchets domestiques, il doit être emmené à un centre de collecte pour l'équipement électrique ou électronique. Sinon, l'utilisateur peut le retourner au détaillant lors de l'achat d'un autre appareil similaire.

L'utilisateur est responsable d'emmener l'appareil à un centre de collecte approprié à la fin de sa vie utile. La collecte sélective appropriée, qui permet le recyclage, le traitement et l'écolement pour durable pour l'environnement, aide à prévenir un impact négatif sur l'environnement et sur la santé des humains, et encourage le recyclage des matériaux composant le produit. Pour PLUS d'informations à propos des systèmes de collecte disponibles, contactez votre service local de disposition des déchets ou la boutique où le produit fut acheté.

PIÈCES DE REMPLACEMENT

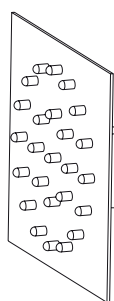

RSSA0011
RSSA0012
RSSA0013
RSSA0025

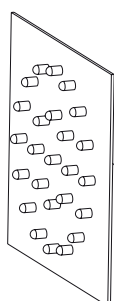

RSSA0008
RSSA0009
RSSA0010
RSSA0018

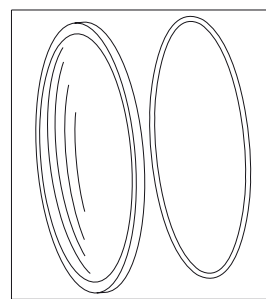

RSSA0001
RSSA0002
RSSA0003
RSSA0026

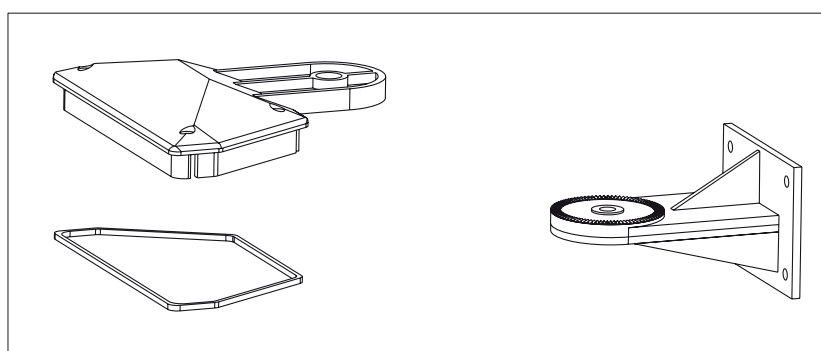

RSSA0004

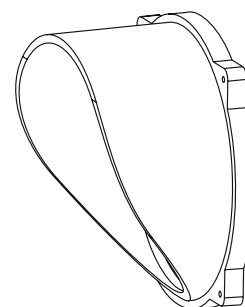

RSSA0005

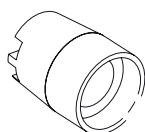

RSSA0007



RSSA0006

ASFK230 Transformateur de 230 V à 24 V

RSSA0001 Lentille rouge avec joint pour feux de circulation Apollo.

RSSA0002 Lentille jaune avec joint pour feux de circulation Apollo.

RSSA0003 Lentille verte avec joint pour feux de circulation Apollo.

RSSA0026 Lentille neutre avec joint pour feux de circulation Apollo.

RSSA0004 Kit de couvercle et joint pour feux de circulation Apollo.

RSSA0005 Visière pour feux de circulation Apollo.

RSSA0006 Lampe 70 W pour feux de circulation Apollo.

RSSA0007 Support à lampe en céramique E27 pour feux de circulation Apollo.

RSSA0008 Circuit 24V ac/dc pour LED rouges.

RSSA0009 Circuit 24V ac/dc pour LED jaunes.

RSSA0010 Circuit 24V ac/dc pour LED vertes.

RSSA0011 Circuit 230V ac avec 25 LED rouges et transformateur.

RSSA0012 Circuit 230V ac avec 25 LED jaunes et transformateur.

RSSA0013 Circuit 230V ac avec 25 LED vertes et transformateur.

RSSA0025 Circuit 230V ac avec 50 LED rouges et transformateur.

RSSA0018 Circuit 24V ac/dc pour 50 LED rouges et vertes.

ATTENTION !!
CONSERVEZ CE FORMULAIRE POUR LA GARANTIE AINSI QUE LE BON D'ACHAT

DONNÉES DU REVENDEUR*

Timbre avec nom, adresse, et numéro de téléphone et signature du revendeur

DONNÉES DE L'INSTALLATEUR*

Timbre avec nom, adresse, et numéro de téléphone et signature de l'installateur

DONNÉES DU PRODUIT

Nom* _____

N° article* _____

N° de série* de l'opérateur* _____

DONNÉES D'ENTRETIEN

Date de l'entretien* _____

Données de la personne en charge de l'entretien (nom, adresse) et signature* _____

DONNÉES DE L'INSTALLATION

Adresse d'installation de l'opérateur * _____

Numéro de tél. du propriétaire de l'opérateur _____

Date d'installation* _____

COMMUNICATIONS



ATENCIÓN



Este manual de instrucciones contiene información importante con respecto a la seguridad: lea todas las instrucciones detenidamente antes de proceder a la instalación. La empresa Stagnoli T.G. S.r.l. no asume ninguna responsabilidad por los daños causados por a un uso inadecuado, erróneo e irrazonable del producto. Conserve este manual con cuidado para poder usarlo en el futuro.

DESTINOS Y LÍMITES DEL USO

Apollo es el semáforo diseñado y producido por Stagnoli T.G. S.r.l. Apollo es diseñado para uso privado, control del tráfico en aparcamientos, calles de áreas de condominios de un solo sentido que se alterna. Apollo NO es un semáforo de uso público, carreteras, autopistas, etc. La empresa Stagnoli T.G. S.r.l. quedará eximida de cualquier responsabilidad en caso de uso e instalación inadecuados.

CARACTERÍSTICAS TÉCNICAS

DATOS TÉCNICOS	Lámpara 230V	Verdes 25 LED		Rojas 25 LED		Amarillas 25 LED	
Fuente de alimentación	230V	24V ac/dc	230V	24V ac/dc	230V	24V ac/dc	230V
Alimentación*	75W	2,4W	3W	2,4W	3W	2,4W	3W
Consumo de corriente	-	0,10A		0,10A		0,10A	
Brillo(Lux)**	10-45lx	14lx		18lx		16lx	
Temperaturas de trabajo	-30° +70° C						
IP	66						

*Para placas de LED alimentadas con 230V, se aplica un transformador de 3VA de máxima potencia

** El brillo se expresa en Lux, pero es relativo a la fuente luminosa

DECLARACIÓN DE CONFORMIDAD



El abajo firmante:
Albiero Lara
Representante legal de Stagnoli T.G. S.r.l.

El fabricante:
Stagnoli T.G. S.r.l.

DECLARA

que los productos nombrados:

Serie APOLLO, semáforos con cuerpo de aluminio,

ASF25L1G - ASF25L1R - ASF25L1V - ASF25L2RV - ASF25L3GRV - ASF25L1G230 - ASF25L1R230 - ASF25L1V230 - ASF25L2RV230
- ASF25L3GRV230 - ASF50L1RV - ASF50L1RV230 - ASF25L2RVD - ASF25L2RV230D - ASF1G - ASF1R - ASF1V - ASF2RV - ASF3GRV

CUMPLEN CON DOS

DIRECTIVAS 2014/30 UE (EMC), 2014/35 UE (LVD), 2011/65 UE (ROHS)

con todas las normas técnicas relativas al producto en el ámbito de aplicación de las directivas comunitarias

EN IEC 61000-6-3:2021

EN IEC 61000-6-2:2019

EN IEC 63000:2018

EN 60068-2-1:2007

EN 60068-2-2:2007

EN 60529: 1991 A1: 2000 / A2:2013 / AC:2016 / AC: 2019

La presente declaración se expide bajo la responsabilidad exclusiva del fabricante y, en su caso, de su representante autorizado.

Lonato del Garda, 10/10/2023

(Lugar y fecha)

(Firma)

DIMENSIONES Y TAMAÑO

SEMÁFORO CON 1 LUZ

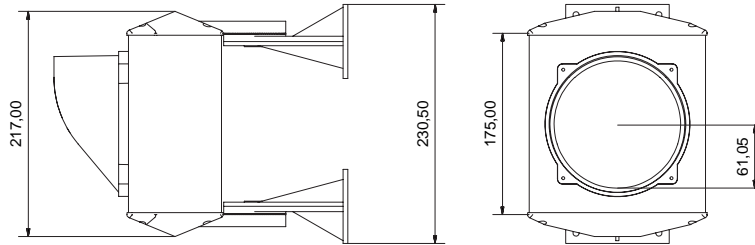

SEMÁFORO CON 2 LUCES

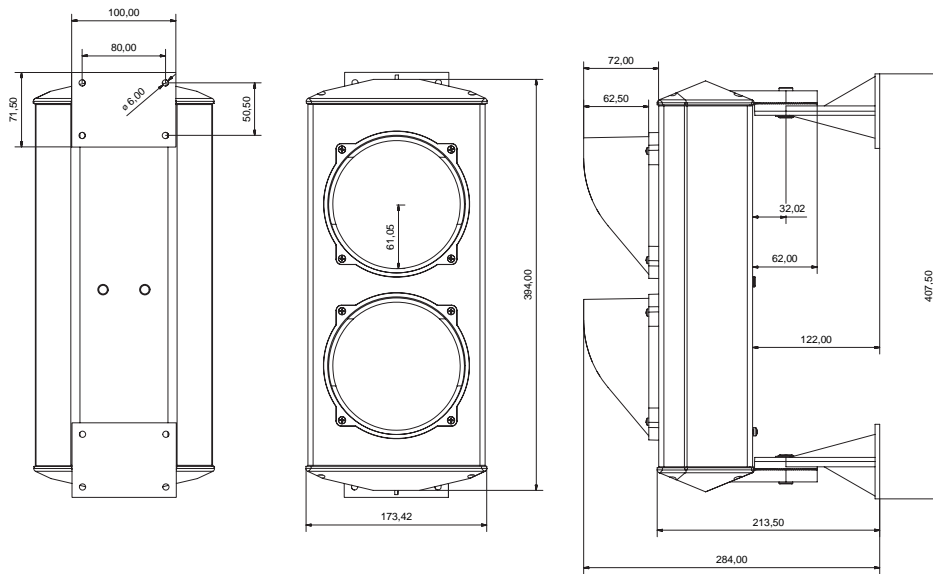

SEMÁFORO CON 3 LUCES

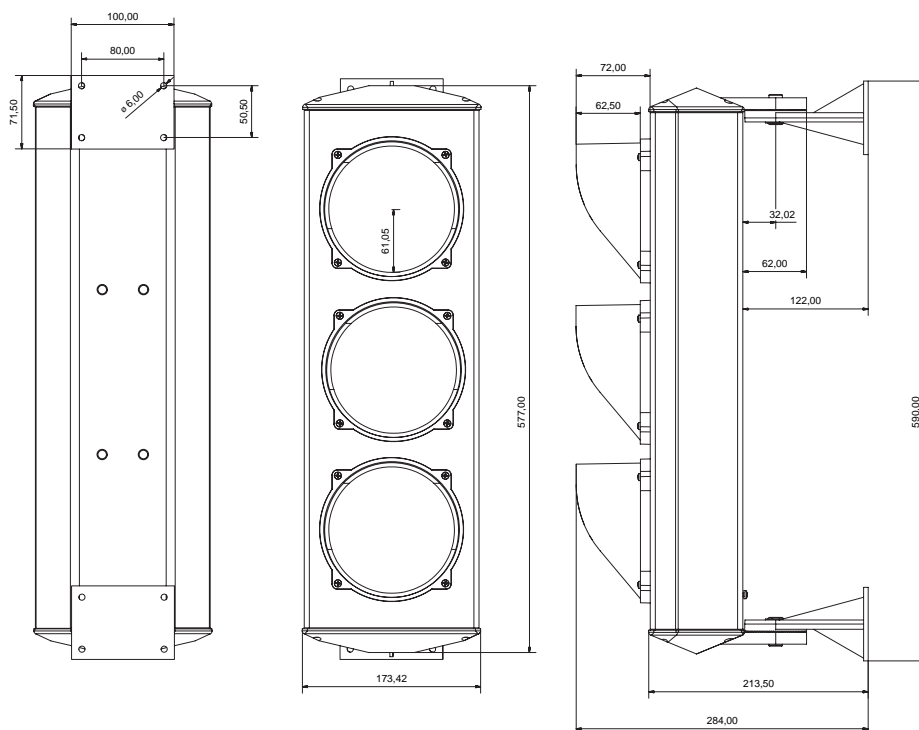

SEMÁFORO CON 3 LUCES

FIJACION DEL CUERPO SOBRE EL SOPORTE

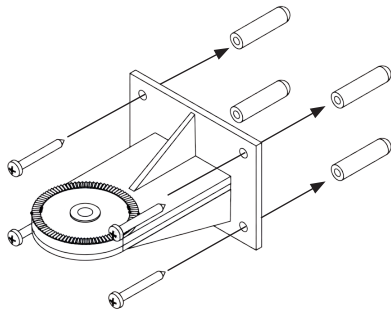

Taladro con broca de 8mm

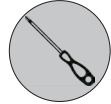

Destornillador Phillips



Destornillador plano



Allen hexagonal Ke N°6

HERRAMIENTAS

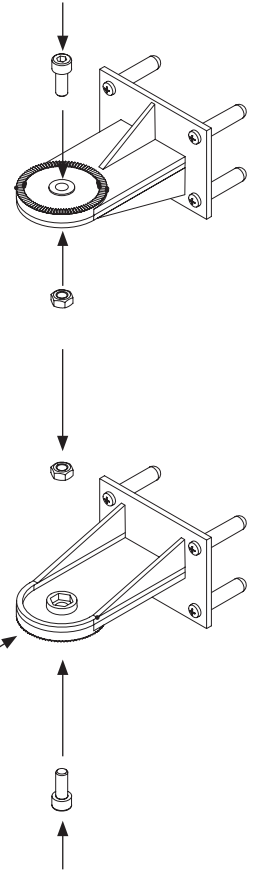
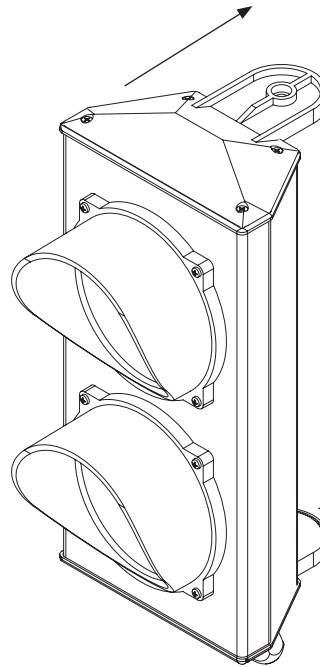
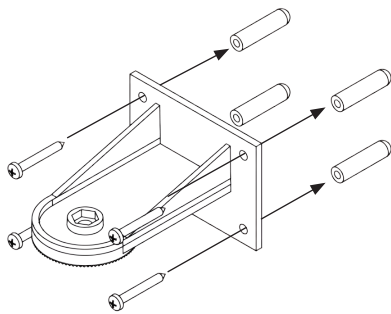

CABLEADO DEL TABLERO DE LED 24V

ASF25L1R

1 LUZ ROJA

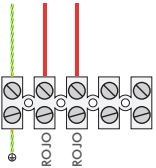

ASF25L1G

1 LUZ AMARILLA

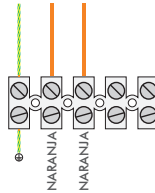

ASF25L1V

1 LUZ VERDE

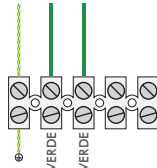

ASF25L2RV

2 LUZ ROJA-VERDE

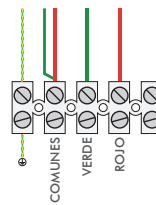

ASF50L1RV

2 LUCES ROJAS-VERDES (50 LED)

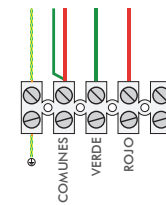

ASF25L3GRV

3 LUCES ROJAS, AMARILLAS Y VERDES

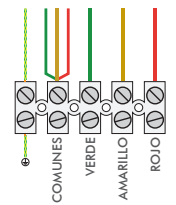

CABLEADO TABLERO DE LED 230V

ASF25L1G230

ASF25L1R230

ASF25L1V230

LUZ ROJA-AMARILLA-VERDE

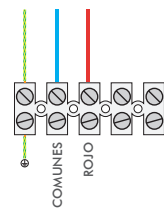

ASF25L2RV230

LUCES ROJAS-VERDES

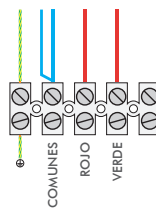

ASF50L1RV230

2 LUCES ROJAS-VERDES (50 LED)

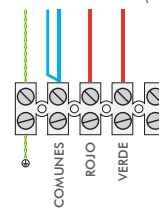

ASF25L3GRV230

3 LUCES ROJAS, AMARILLAS Y VERDES

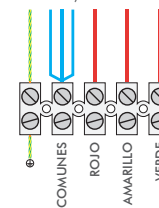

CABLEADO DE LÁMPARA DE 230V

ASF1G
ASF1R
ASF1V

1 LUZ ROJA-AMARILLA-VERDE

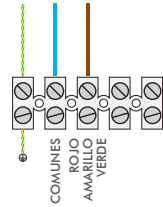

ASF2RV

2 LUZ ROJA-AMARILLA-VERDE

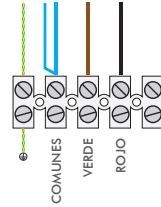

ASF3GRV

3 LUCI ROJO-AMARILLA-VERDE

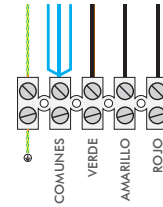

MONTAJE DE LA CUBIERTA EN EL SEMÁFORO

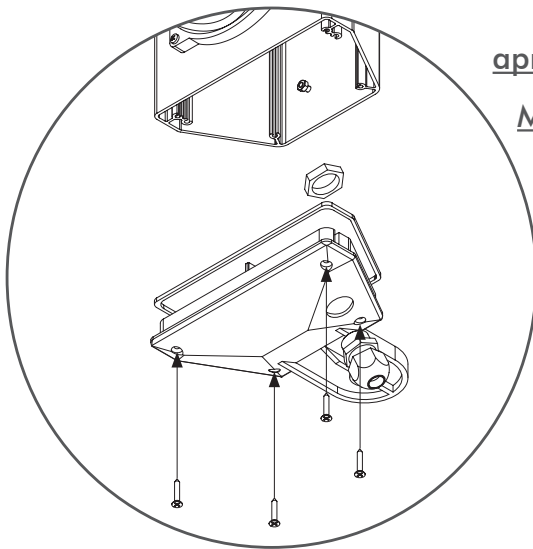

N.B.
apretar los tornillos
MIN: 4,5Nm

HERRAMIENTAS
DE UTILIDAD

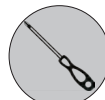

Destornillador
Phillips

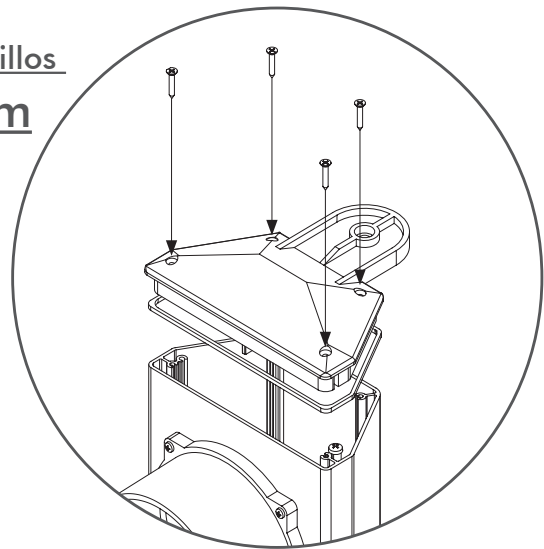

ELIMINACIÓN



Los componentes del embalaje -cartón o plástico- pueden reciclarse a través de la recogida selectiva. Por otra parte, en el caso de la eliminación del producto, hay que prestar mucha atención a los componentes que pueden contener contaminantes, como placas de circuitos, etc. Éstos deben recuperarse o eliminarse en centros especiales o en instalaciones autorizadas. En este caso, es necesario remitirse a la normativa específica vigente en el lugar de la eliminación.
EVITAR DESECHARLO AL MEDIO AMBIENTE.

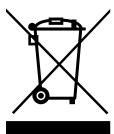

El símbolo de la papelera tiene que tachada en el aparato o en su embalaje significa que al final de su vida útil, ser tratado por separado de los residuos domésticos, y debe llevarse a un centro de recogida separado para los aparatos eléctricos y electrónicos.

El usuario es responsable de trasladar el aparato al final de su vida útil a las instalaciones de recogida apropiadas. La recogida separada apropiada que permite, el consiguiente reciclado, tratamiento y eliminación compatible con el medio ambiente ayuda a prevenir el impacto negativo en el medio ambiente y en la salud humana, además de promover el reciclado de los materiales que componen el producto. Para **MÁS** información detallada sobre los sistemas de recogida disponibles, póngase en contacto con el servicio local de eliminación de residuos o con la tienda donde se realizó la compra.

REPUESTOS

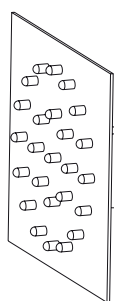

RSSA0011
RSSA0012
RSSA0013
RSSA0025

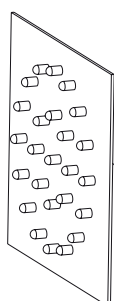

RSSA0008
RSSA0009
RSSA0010
RSSA0018

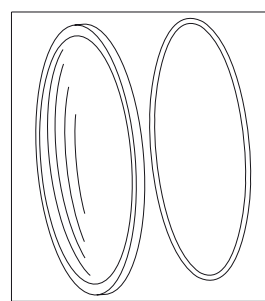

RSSA0001
RSSA0002
RSSA0003
RSSA0026

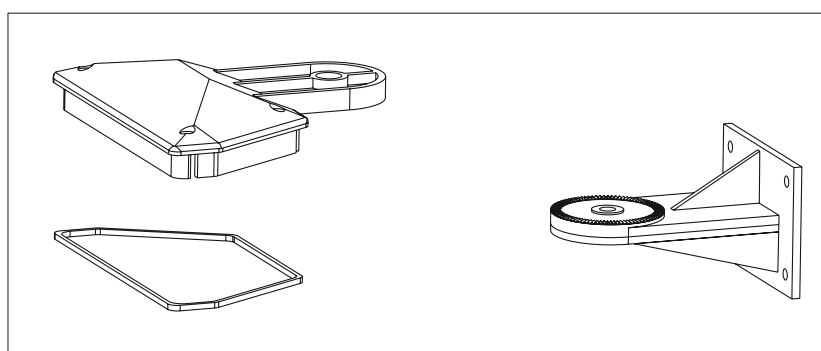

RSSA0004

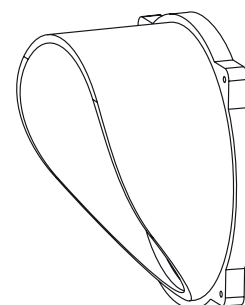

RSSA0005

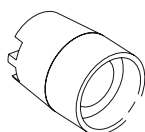

RSSA0007



RSSA0006

Transformador ASFK230 de 230V a 24V

RSSA0001 Lente roja con junta para los semáforos Apollo.

RSSA0002 Lente amarilla con junta para los semáforos Apollo.

RSSA0003 Lente verde con junta para los semáforos Apollo.

RSSA0026 Lente neutra con junta para los semáforos Apollo.

RSSA0004 Kit compuesto por tapa soporte y junta para semáforos Apollo.

RSSA0005 Parasol para semáforos Apollo.

RSSA0006 Lámpara de 70W para semáforos Apollo.

RSSA 0007 E27 portalámparas cerámico para semáforos Apollo y Apollo-plast.

RSSA0008 Tarjeta de 24V ac/dc con 25 LED rojas.

RSSA0009 Tarjeta de 24V ac/dc con 25 LED amarillas.

RSSA0010 Tarjeta de 24V ac/dc con 25 LED verdes.

RSSA0011 de 230V ac con 25 LED rojas y transformador.

RSSA0012 Tarjeta de 230V ac con 25 LED amarillas y transformador.

RSSA0013 Tarjeta de 230V ac con 25 LED verdes y transformador.

RSSA0025 Tarjeta de 230V ac con 50 LED rojas y verdes, transformador incluido.

RSSA0018 Tarjeta de 24V ac/dc con 50 LED rojas y verdes.

¡¡ATENCIÓN!!
CONSERVAR ESTA HOJA CUMPLIMENTADA JUDO CON EL DOCUMENTO COMPROBANTE DE LA COMPRA DEL PRODUCTO A MOSTRAR PARA HACER VALER LA GARANTIA

DATOS DEL VENDEDOR*

Sello – con indicación del nombre, dirección y número de teléfono – y firma del Vendedor

DATOS DEL INSTALADOR*

Sello – con indicación del nombre, dirección y número de teléfono – y firma del vendedor

DATOS DEL PRODUCTO

Nombre* _____

Código* _____

Nº. de serie* del motor _____

DATOS DE MANTENIMIENTO

Fcha de la intervención* _____

Datos del operador
(nombre, dirección)
y firma del operador* _____

DATOS DE LA INSTALACIÓN

Dirección del lugar donde ha sido instalado el sistema* _____

Nº. de tel. del propietario de la instalación _____

Fecha de la instalación* _____

EVENTUALES INDICACIONES



ACHTUNG



Diese Bedienungsanleitung enthält wichtige Informationen zur Sicherheit: Lesen Sie alle Anweisungen sorgfältig durch, bevor Sie mit der Installation fortfahren. Die Firma Stagnoli übernimmt keine Verantwortung für Schäden, die durch unsachgemäßen, fehlerhaften und unangemessenen Gebrauch des Produkts entstehen. Bewahren Sie diese Bedienungsanleitung auch für den zukünftigen Gebrauch sorgfältig auf.

BESTIMMUNGSRORTE UND EINSATZBESCHRÄNKUNGEN

Apollo ist eine von Stagnoli T.G. s.r.l. entwickelte und produzierte Ampel. Apollo ist für den Privatgebrauch, das Management von Parkplätzen, abwechselnden Einbahnstraßen und Wohngebieten gedacht. Apollo ist KEINE Ampel für den öffentlichen Einsatz, Straßen, Autobahnen usw. Die Firma Stagnoli ist im Falle einer unsachgemäßen Verwendung und Installation von jeglicher Verantwortung befreit.

TECHNISCHE MERKMALE

TECHNISCHE DATEN	Lampe 230V	Grün 25 LED		Rot 25 LED		Gelb 25 LED	
Stromversorgung	230V	24V ac/dc	230V	24V ac/dc	230V	24V ac/dc	230V
Leistung*	75W	2,4W	3W	2,4W	3W	2,4W	3W
Nominaler Stromverbrauch	-	0,10A		0,10A		0,10A	
Helligkeit*	10-45lx	14lx		18lx		16lx	
Betriebstemperaturen	-30° +70° C						
IP	66						

*Für 230V-betriebene LED-Tafeln wird ein 3VA-Transformator maximaler Leistung verwendet.

** Die Helligkeit wird in Lux, angegeben, ist aber relativ zur Lichtquelle.

KONFORMITÄTSERKLÄRUNG



Unterzeichnender:
Albiero Lara
Rechtlicher Vertreter von Stagnoli T.G. S.r.l.

Hersteller:
Stagnoli T.G. S.r.l.

ERKLÄRT,
dass die Produkte namens:

APOLLO-Serie, Ampeln mit Aluminiumgehäuse

ASF25L1G - ASF25L1R - ASF25L1V - ASF25L2RV - ASF25L3GRV - ASF25L1G230 - ASF25L1R230 - ASF25L1V230 - ASF25L2RV230
- ASF25L3GRV230 - ASF50L1RV - ASF50L1RV230 - ASF25L2RVD - ASF25L2RV230D - ASF1G - ASF1R - ASF1V - ASF2RV - ASF3GRV

KONFORM

RICHTLINIEN 2014/30 UE (EMC), 2014/35 UE (LVD), 2011/65 UE (ROHS)
mit allen technischen Normen sind, die für die Produkte innerhalb des Anwendungsbereichs der EU-Richtlinien gelten

EN IEC 61000-6-3:2021
EN IEC 61000-6-2:2019
EN IEC 63000:2018
EN 60068-2-1:2007
EN 60068-2-2:2007

EN 60529: 1991 A1: 2000 / A2:2013 / AC:2016 / AC: 2019

Diese Erklärung wird in alleiniger Verantwortung des Herstellers und, falls zutreffend, seines Bevollmächtigten ausgestellt

Lonato del Garda, 10/10/2023

(Ort und Datum)

(Unterschrift)

ABMESSUNGEN UND GRÖSSE

AMPEL MIT 1 LICHT

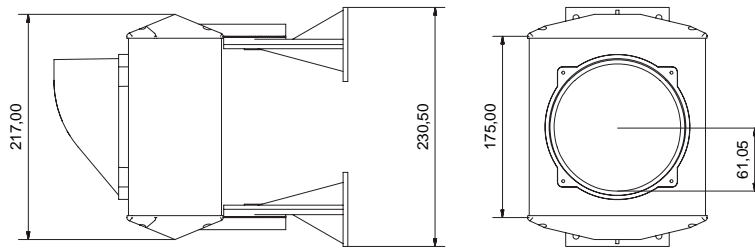

AMPEL MIT 2 LICHTERN

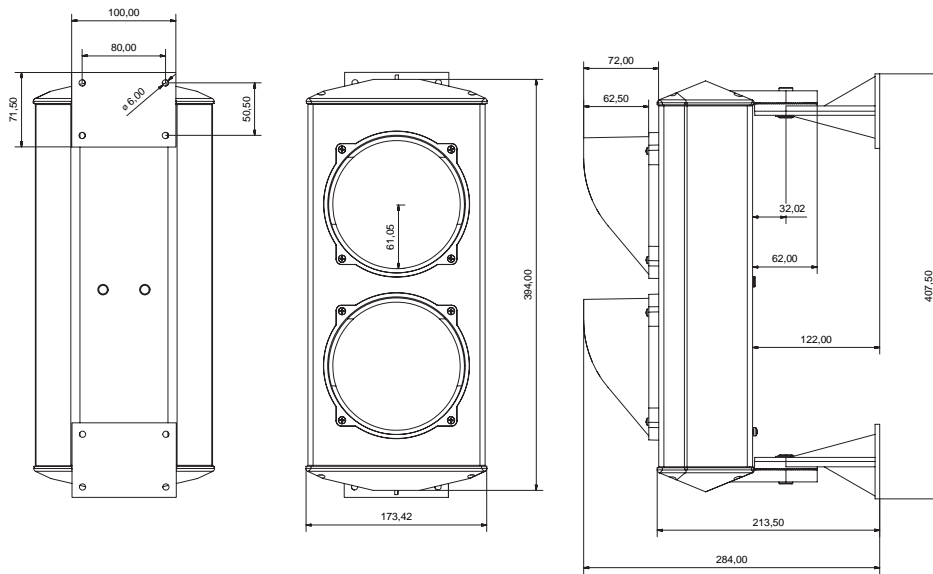

AMPEL MIT 3 LICHTERN

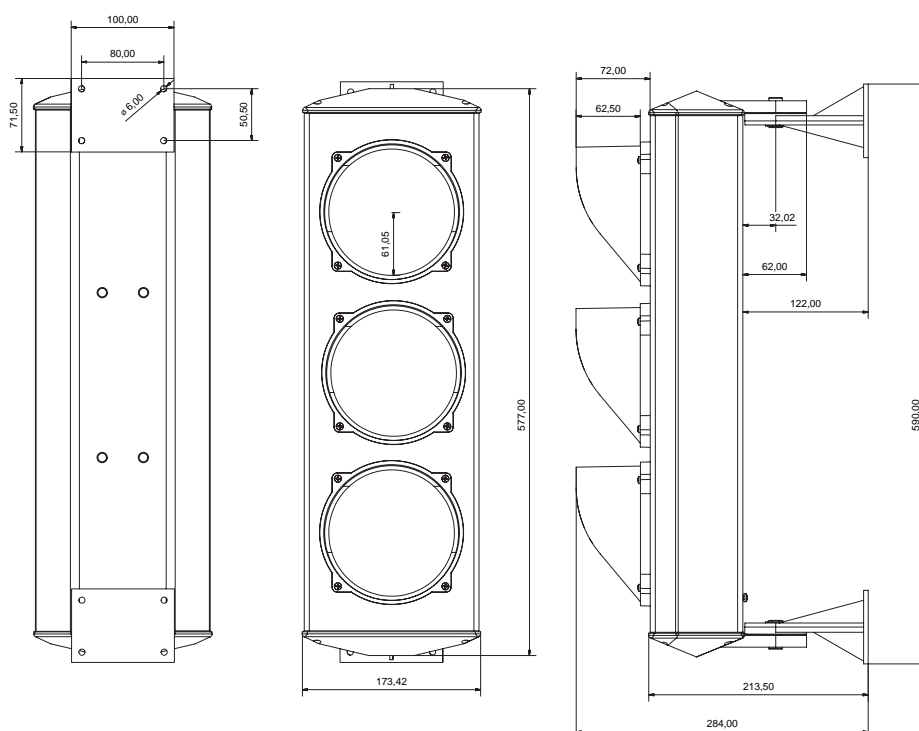

BEFESTIGUNG DER WANDHALTERUNG

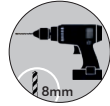
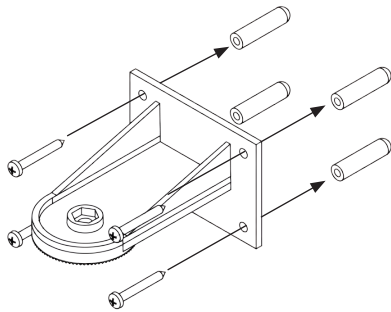
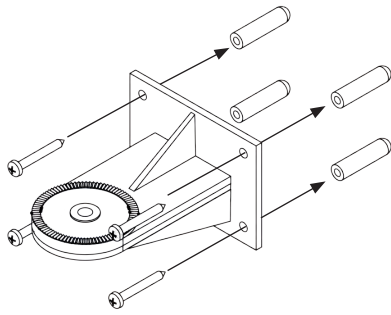

8 mm-Bohrer

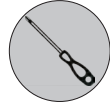

Kreuzschraubenzieher

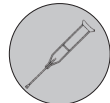

Flachschraubenzieher



Sechskant-Inbusschlüssel Nr. 6

NÜTZLICHE WERKZEUGE

GEHÄUSEBEFESTIGUNG AN HALTERUNG

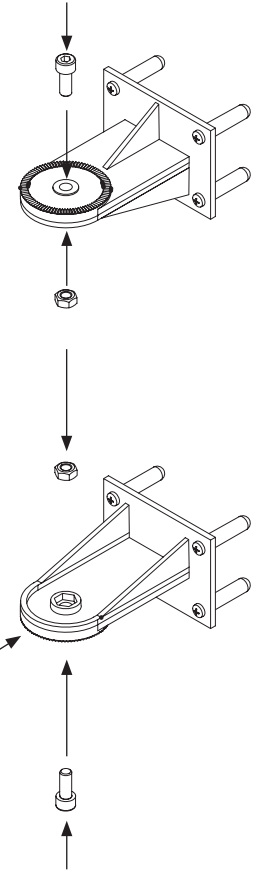
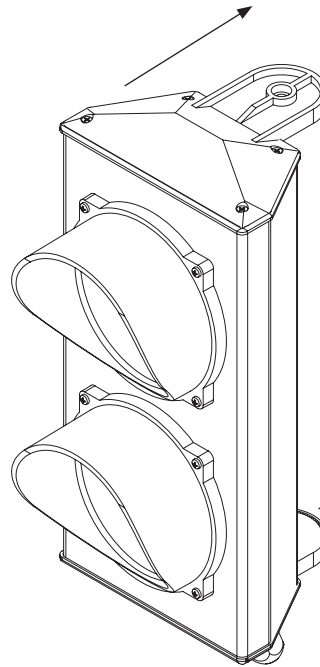

24V LED-BORDVERKABELUNG

ASF25L1R

1 ROTES LICHT

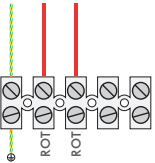

ASF25L1G

1 GELBES LICHT

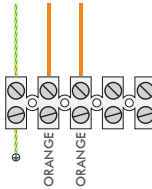

ASF25L1V

1 GRÜNES LICHT

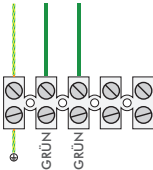

ASF25L2RV

2 ROT-GRÜN-LICHTER

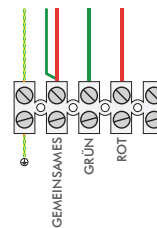

ASF50L1RV

2 ROT-GRÜN-LICHTER (50 LEDs)

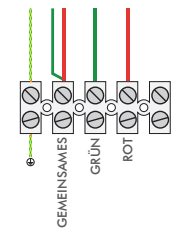

ASF25L3GRV

3 ROT-GELB-GRÜN-LICHTER

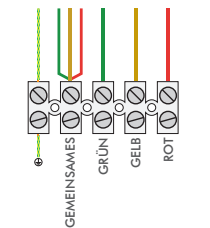

230V LED-BORDVERKABELUNG

ASF25L1G230

ASF25L1R230

ASF25L1V230

1 ROT-GELB-GRÜN-LICHT

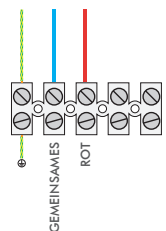

ASF25L2RV230

2 ROT-GRÜN-LICHTER

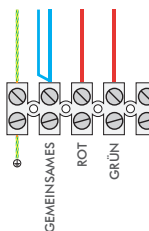

ASF50L1RV230

2 ROT-GRÜN-LICHTER (50 LEDs)

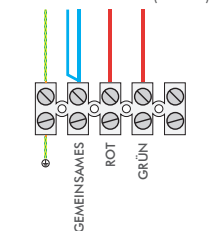

ASF25L3GRV230

3 ROT-GELB-GRÜN-LICHTER

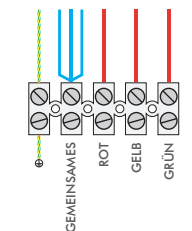

230V LAMPENVERKABELUNG

ASF1G
ASF1R
ASF1V

1 ROT-GELB-GRÜN-LICHT

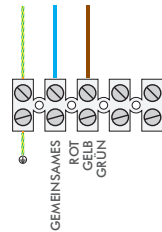

ASF2RV

2 ROT-GRÜN-LICHTER

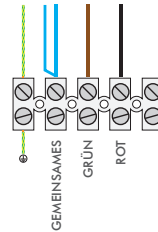

ASF3GRV

3 ROT-GELB-GRÜN-LICHTER

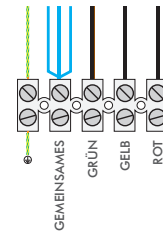

ABDECKUNGSMONTAGE AN DER AMPEL

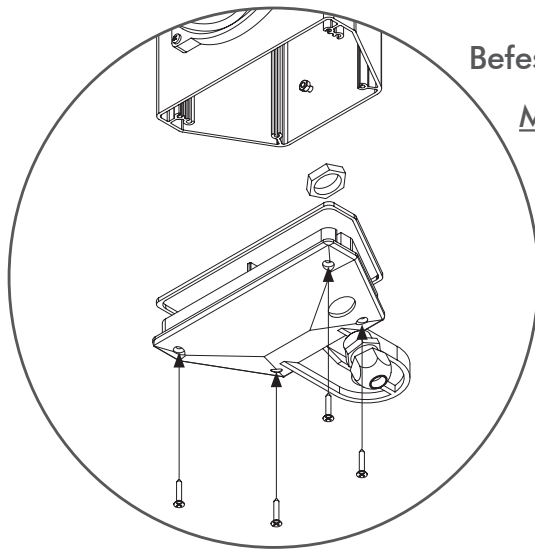

HINWEIS
Befestigungsschrauben
MIN: 4,5Nm

**NÜTZLICHE
WERKZEUGE**

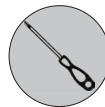

Kreuzschraubenzieher

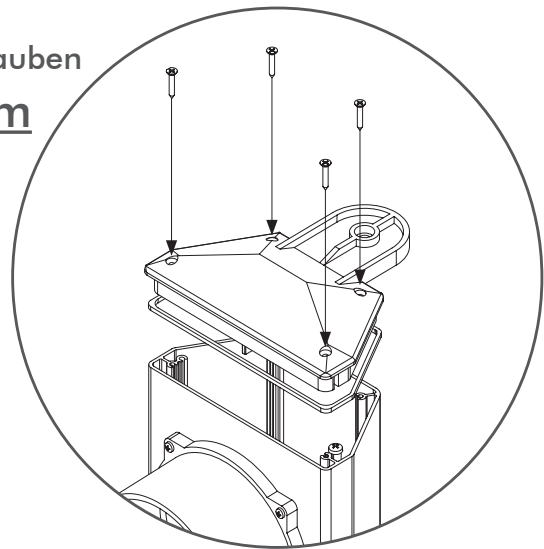

ENTSORGUNG



Die Verpackungsbestandteile, Karton oder Kunststoff, können durch getrennte Entsorgung wiederverwertet werden. Bei der Entsorgung des Produkts hingegen ist besonders auf Komponenten zu achten, die Schadstoffe enthalten können, wie z.B. Leiterplatten, usw., die in speziellen Zentren oder durch autorisierte Einrichtungen verwertet oder entsorgt werden müssen. In diesem Fall ist es notwendig, auf die spezifischen Vorschriften zu achten, die am Entsorgungsort gelten.
EINE ABGABE AN DIE UMWELT VERMEIDEN.

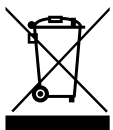

Das Symbol der durchgestrichenen Abfalltonne auf Gerät oder Verpackung bedeutet, dass das Gerät am Ende seiner Nutzungsdauer, getrennt vom Hausmüll, zu einer getrennten Sammelstelle für Elektrogeräte gebracht werden muss. Der Benutzer kann es beim Kauf eines neuen gleichwertigen Gerätetyps auch an den Einzelhändler zurückgeben.

Der Benutzer ist für die Zuführung des Geräts am Ende seiner Lebensdauer an die entsprechenden Sammelstellen verantwortlich. Die fachgerechte getrennte Sammlung, die eine anschließende Wiederverwertung, Behandlung und umweltverträgliche Entsorgung ermöglicht, hilft, negative Auswirkungen auf die Umwelt und die menschliche Gesundheit zu vermeiden, und fördert das Recycling der Materialien, aus denen das Produkt besteht. NÄHERE Informationen zu den verfügbaren Sammelsystemen erhalten Sie bei der örtlichen Abfallentsorgungsstelle oder im Geschäft, in dem Sie das Produkt gekauft haben.

ERSATZTEILE

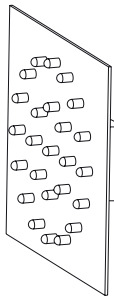

RSSA0011
RSSA0012
RSSA0013
RSSA0025

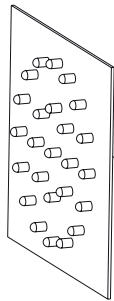

RSSA0008
RSSA0009
RSSA0010
RSSA0018

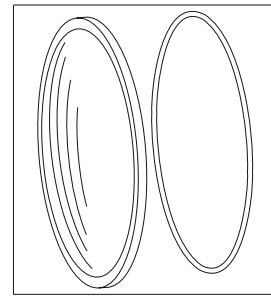

RSSA0001
RSSA0002
RSSA0003
RSSA0026

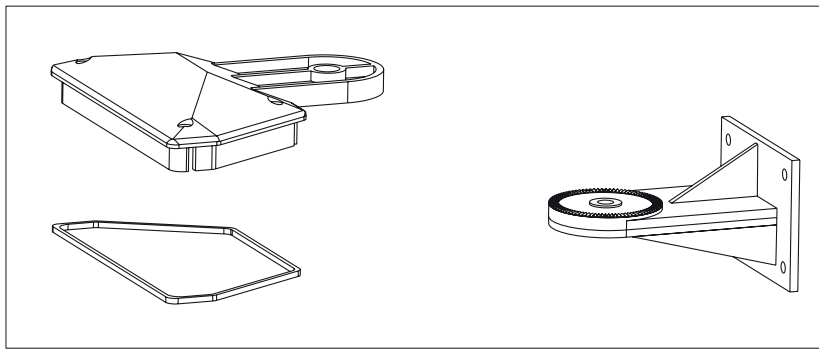

RSSA0004

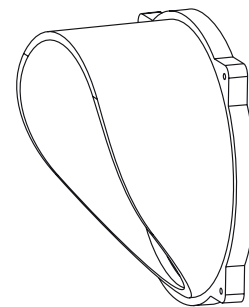

RSSA0005

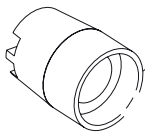

RSSA0007



RSSA0006

ASFK230 Trafo von 230V auf 24V

RSSA0001 Rote Linse mit Dichtung für Apollo-Ampeln.

RSSA0002 Gelbe Linse mit Dichtung für Apollo-Ampeln.

RSSA0003 Grüne Linse mit Dichtung für Apollo-Ampeln.

RSSA0026 Neutrale Linse mit Dichtung für Apollo-Ampeln.

RSSA0004 Set bestehend aus Halterungsabdeckung und Dichtung für Apollo-Ampeln.

RSSA0005 Sonnenblende für Apollo-Ampeln.

RSSA0006 70W Lampe für Apollo-Ampeln.

RSSA 0007 E27 Keramik-Lampenhalter für Apollo-Ampeln.

RSSA0008 24V ac/dc-Karte mit 25 roten LEDs.

RSSA0009 24V ac/dc-Karte mit 25 gelben LEDs.

RSSA0010 24V ac/dc-Karte mit 25 grünen LEDs.

RSSA0011 230V ac-Bord mit 25 roten LEDs und Trafo.

RSSA0012 230V ac-Bord mit 25 gelben LEDs und Trafo.

RSSA0013 230V ac-Bord mit 25 grünen LEDs und Trafo.

RSSA0025 230V ac-Bord mit 50 roten und grünen LEDs inkl. Trafo.

RSSA0018 24V ac/dc-Karte mit 50 roten und grünen LEDs

ACHTUNG!!
BITTE BEHALTEN SIE DIESES FORMULAR ZUSAMMEN MIT DEM EINKAUFSSCHEIN ZUM

VERKÄUFERANGABEN*

Stempel mit Namen, Adresse, Telefonnummer und Unterschrift des Verkäufers

INSTALLATEURANGABEN*

Stempel mit Namen, Adresse, Telefonnummer und Unterschrift des Installateurs

PRODUKT ANGABEN

Name*

Artikelnummer*

Serien-Nr. des Antriebs*

SERVICE-ANGABEN

Datum des Service*

Angaben des Mitarbeiters,
der die Wa rtung durchgeführt hat.
(Name und Adresse)*

INSTALLATIONSANGABEN
Adresse des Installationsortes

Telefonnummer des
Antriebsbesitzers

Installationsdatum*

WICHTIGE MITTEILUNGEN



Stagnoli T.G. S.r.l. - via Mantova Traversa 1, 105 a/b
25017 Lonato del Garda - Brescia - Italia
tel (+39) 030.9139511 fax (+39) 030.9139580
www.stagnoli.com